

Read entire instructions thoroughly before starting. References to the service manual will be required for adjustments, fastener torques, and diagnosis.

**NOTE:**

PLEASE NOTE IF YOU HAVE #8 WIRING HARNESS INSTALLED IN YOUR JEEP ALREADY YOU CAN RETURN IT FOR A \$50 CREDIT, PLEASE CALL FOR RETURN LABEL OR ADDRESS- 877-855-7787

**TOOLS REQUIRED:**

- Steering wheel puller tool
- Modeler's knife
- Phillips head screwdriver
- Torx head screwdrivers
- Complete metric socket set
- Pin drill
- 3/32" drill bit
- Small flat head screwdriver
- Needle-nose pliers
- Long, narrow punch

**CONTENTS:**

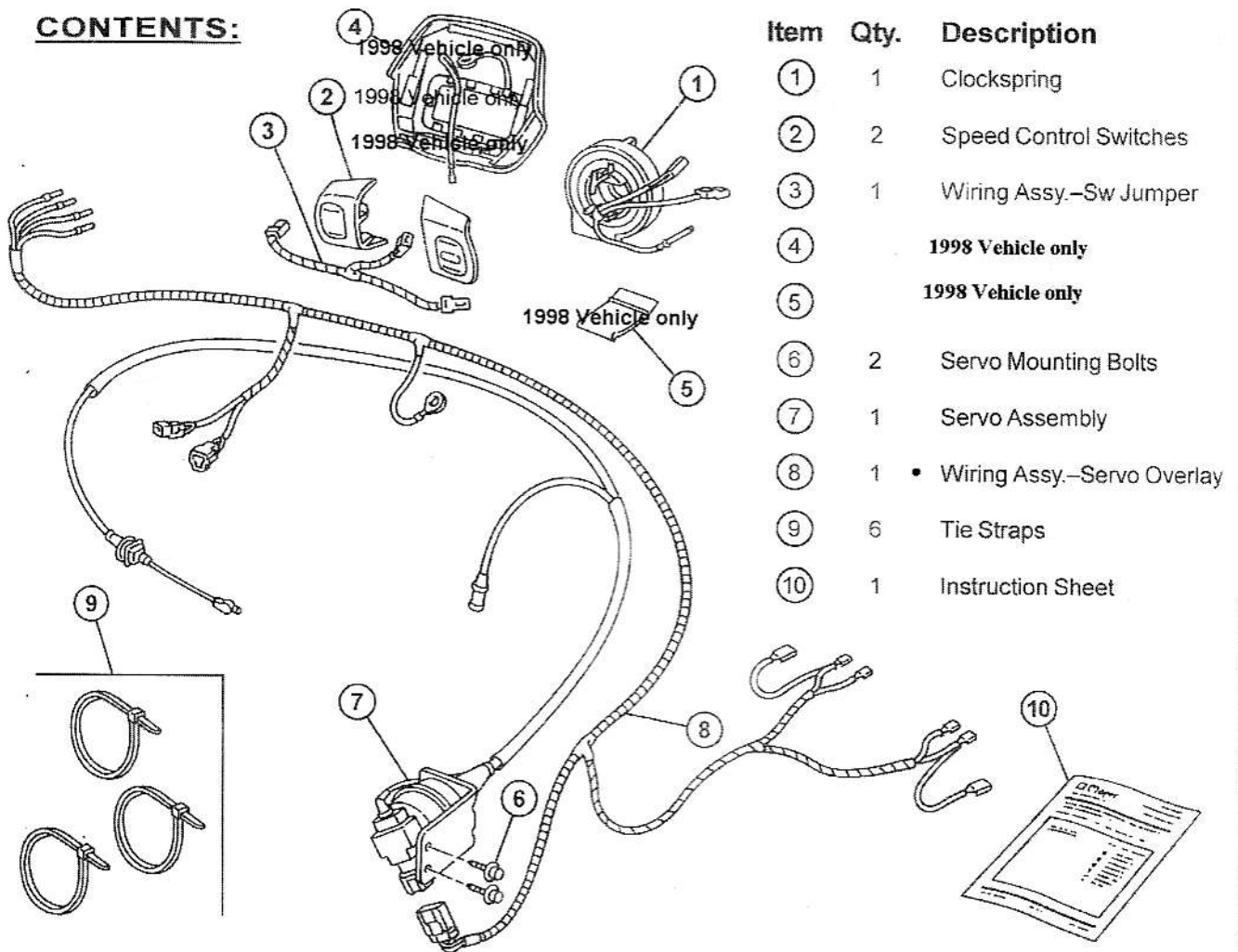

Item	Qty.	Description
①	1	Clockspring
②	2	Speed Control Switches
③	1	Wiring Assy.-Sw Jumper
④		1998 Vehicle only
⑤		1998 Vehicle only
⑥	2	Servo Mounting Bolts
⑦	1	Servo Assembly
⑧	1	Wiring Assy.-Servo Overlay
⑨	6	Tie Straps
⑩	1	Instruction Sheet